

## Quick Start Guide (A16381M8J9\_D)

Illustra Standard Gen 3 2MP & 5MP Bullet cameras  
(P/N's ISIN-B02M031-N and ISIN-B05M031-N)

**Note:** Please visit [illustracameras.com](http://illustracameras.com) for access to firmware updates that include new features, cyber-security enhancements and bug fixes.

### In the box

- 1 x Standard Gen 3 Bullet Camera
- 1 x Quick Start Guide
- 1 x T10 Secure Torx drive bit
- 2 x ST 4x30mm Phillips screws
- 2 x Fischer 4x30mm screw anchors
- 1 x T9 Secure Torx Drive bit
- 1 x Drill template
- 1 x Waterproof RJ45 cable accessory
- 1 x Terminal Block Connector for Alarm IN/OUT

### Installation tools

- 1 x Phillips's screwdriver
- 1 x Drill
- 1 x L-Type Allen key
- 1 x M4 Wrench



Table 1: Standard Gen 3 Bullet camera parts descriptions

Number	Description
1	Camera lens
2	Camera body
3	Wall Mount
4	Pre-Fitted wall mount foam insert
5	Pre-Fitted RJ45 cable and other connections
6	Camera arm rotational adjustment screw (360 degrees)
7	Camera body tilt adjustment screw (180 degrees)
8	Camera body rotational adjustment screw (360 degrees)
9	SD Card and reset button cover

### Quick reference

- Default IP: 192.168.1.168 (DHCP enabled)
- Default Username / Password: admin / admin
- Power: PoE IEEE 802.3af Class 3 or 12V DC / 50-60Hz / 1A

### Mounting and powering up the camera

1. Place the mounting template sticker on the surface that you want to attach the camera.
2. On the surface drill two 5.5mm screw holes as per the markings identified with a '1' on the drill template.

### Mounting and powering up the camera (continued)

5. Connect the Alarm IN/OUT matting connector (Figure 3) with the relevant connector cable.
6. Hold the camera wall mount (2) (Figure 2) up to the surface and insert the cable through the hole on the surface or through the cable side entry hole on the camera base.
7. Align the two holes on the camera mount with the two holes on the wall and insert the two ST 4x30mm screws (1) (Figure 2) into the two holes and securely attach the camera to the wall
8. Use the T10 Secure Torx drive bit to loosen the screw (6) (Figure 1) and rotate the camera arm as required (+/- 360 degrees).
9. Use the T10 Secure Torx drive bit to loosen the screw (7) (Figure 1) and tilt the camera body as required (+/- 180 degrees).
10. Use the T10 Secure Torx drive bit to loosen the screw (8) (Figure 1) and rotate the camera body as required (+/- 360 degrees).
11. Connect the 12V DC cable to the 12V DC terminal **or** connect the RJ-45 jack to a PoE compatible network device that supplies power through the Ethernet cable.

**Note:** See Figure 3 for additional information on all cable connections on the RJ45 cable.

Figure 1: Standard Gen 3 Bullet camera parts

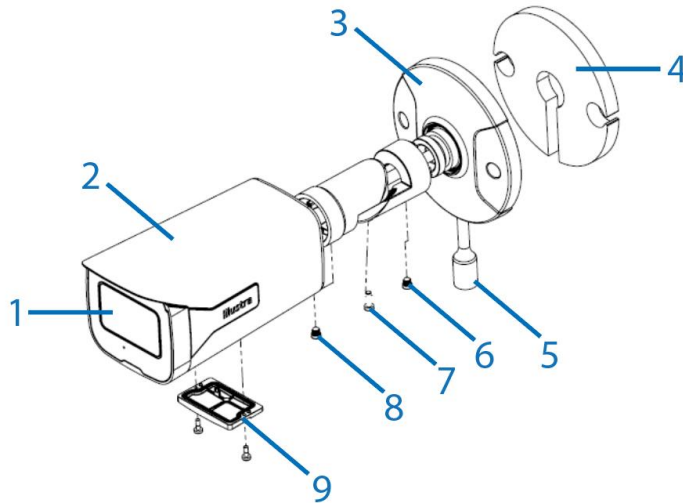

Figure 1

### Mounting and powering up the camera (continued)

3. You can route all cabling through the surface or through the cable side entry hole on the camera.
  - If you are routing the cabling through the surface, then cut out a cable hole as per the markings identified with an 'A' on the drill template.
  - OR**
  - If you are routing the cabling through the cable side entry hole on the camera base, then cut out a hole as per the marking identified with an 'B' on the drill template.
4. Securely place two Fischer 4x30mm screw anchors (3) (Figure 2) into the two 5.5 mm holes on the surface.

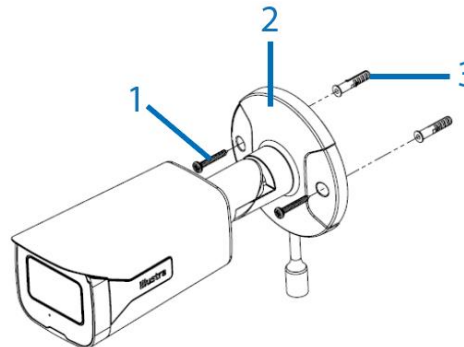

Figure 2

### Mounting and powering up the camera (continued)

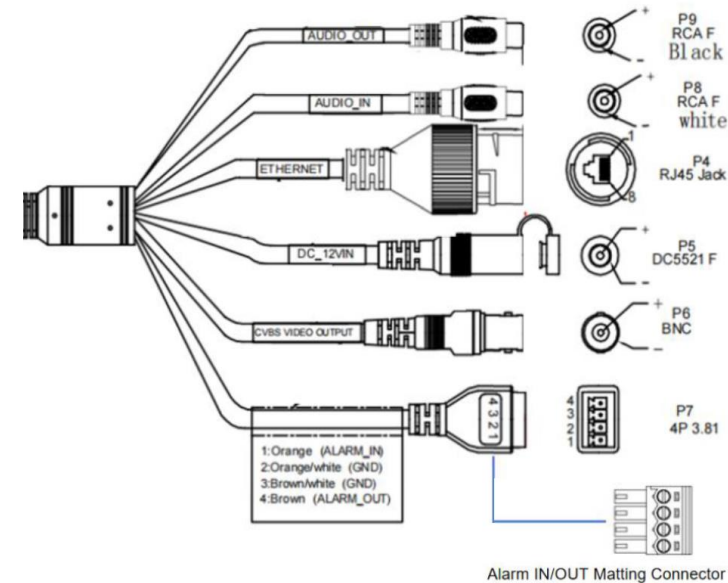

Figure 3

### Inserting or removing an SD card

1. Use the T9 secure Torx drive bit to loosen the two M2.5x6mm captive screws (1) (Figure 4) on the SD card cover (2) (Figure 4) and insert or remove the SD card (3) (Figure 4).

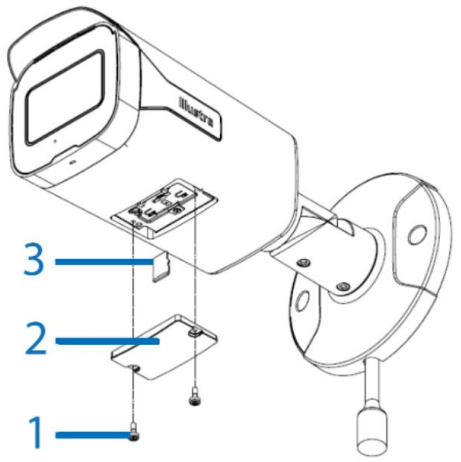

Figure 4

### Accessing the cameras internal buttons

1. Use the T9 secure Torx drive bit to loosen the two M2.5x6mm captive screws (1) (Figure 4) on the SD card cover (2) (Figure 4).  
**Note:** The 'Hardware reset button' (1) (Figure 5) and 'Factory reset button' (2) (Figure 5) are now visible.

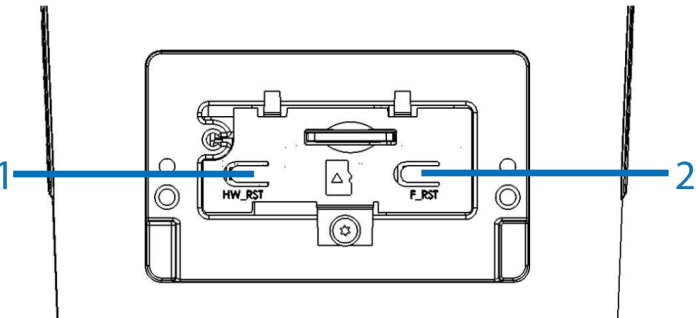

Figure 5

- Press and hold the Hardware reset button for **5** seconds to reboot the hardware.
- Press and hold the Factory reset button for **5** seconds to preserve the IP Address or for 20 Seconds to reset to factory default settings.

### Warnings

1. Installation and service should be performed only by qualified and experienced technicians and comply with all local codes and rules to maintain your warranty.
2. These units operate at PoE IEEE 802.3af Class 3 or 12V DC / 50-60Hz / 1A.
3. Wipe the camera with a dry soft cloth. For tough stains, slightly apply with diluted neutral detergent and wipe with a dry soft cloth.
4. Do not apply benzene or thinner to the camera, which may cause the surface of the unit to melt or lens to be fogged.
5. Avoid operating or storing the unit in the following locations:
  - Near fluorescent lamps or objects with reflections.
  - Under unstable or flickering light sources.